



NMO 3/4" Hole Mounts High Frequency Fully Shielded NMO Mount Standard Thickness Mounting

- Low loss up to 1.5 GHz • Zinc diecast enclosed mount • Solid brass NMO ring
- Small gold contact pin

Model	Installed Connector	Coax Conductor	Description
1258	No-Conn.	Stranded	Mnt.w/17' RG-58
1258-24	No-Conn.	Stranded	Mnt.w/24' RG-58
1258-UHF	UHF/PL-259	Stranded	Mnt.w/17' RG-58
1259	No-Conn.	Solid	Mnt.w/17' RG-58
1259-24	No-Conn.	Solid	Mnt.w/24' RG-58
1259-FME	FME (female)	Solid	Mnt.w/17' RG-58
1259-MUHF	Mini-UHF	Solid	Mnt.w/17' RG-58
1259-SMA	SMA	Solid	Mnt.w/17' RG-58

Not Installed Connectors

1258-L-CUHF	Crimp UHF	Stranded	Mnt.w/17' RG-58
1258-L-MUHF	Mini-UHF	Stranded	Mnt.w/17' RG-58
1259-L-CUHF	Crimp UHF	Solid	Mnt.w/17' RG-58
1259-L-MUHF	Mini-UHF	Solid	Mnt.w/17' RG-58

NMO 3/4" Hole Mounts Standard Thickness Mounting

Solid Brass w/Gold Contact Pin • 0-1000 MHz

Model	Installed Connector	Coax Conductor	Description
1250	UHF/PL259	Stranded	Mnt.w/17' RG-58
1251	No-Conn.	Stranded	Mnt.w/17' RG-58
1251-24	No-Conn.	Stranded	Mnt.w/24' RG-58
1251-30	No-Conn.	Stranded	Mnt.w/30' RG-58
1251-MUHF	Mini-UHF	Stranded	Mnt.w/17' RG-58
1252	No-Conn.	Solid	Mnt.w/17' RG-58
1252-24	No-Conn.	Solid	Mnt.w/24' RG-58
1252-30	No-Conn.	Solid	Mnt.w/30' RG-58
1252-BNC	BNC	Solid	Mnt.w/17' RG-58
1252-FME	FME (female)	Solid	Mnt.w/17' RG-58
1252-MUHF	Mini-UHF	Solid	Mnt.w/17' RG-58
1252-SMA	SMA	Solid	Mnt.w/17' RG-58
1252-FSMA	SMA (female)	Solid	Mnt.w/17' RG-58
1252-TNC	TNC	Solid	Mnt.w/17' RG-58

1254 - - Mount Only

Not Installed Connectors

1251-L-CUHF	Crimp UHF	Stranded	Mnt.w/17' RG-58
1251-L-MUHF	Mini-UHF	Stranded	Mnt.w/17' RG-58
1252-L-CUHF	Crimp UHF	Solid	Mnt.w/17' RG-58
1252-L-MUHF	Mini-UHF	Solid	Mnt.w/17' RG-58

NMO 3/4" Hole Mounts • Fits 3/8" to 3/4" Hole

Standard Thickness Mounting

Solid Brass w/Gold Contact Pin • 0-1000 MHz

Model	Installed Connector	Coax Conductor	Description
2250	UHF/PL-259	Stranded	Mnt.w/17' RG-58
2251	No-Conn.	Stranded	Mnt.w/17' RG-58
2251-24	No-Conn.	Stranded	Mnt.w/24' RG-58
2251-30	No-Conn.	Stranded	Mnt.w/30' RG-58
2252	No-Conn.	Solid	Mnt.w/17' RG-58
2252-24	No-Conn.	Solid	Mnt.w/24' RG-58
2252-30	No Conn.	Solid	Mnt.w/30' RG-58
2252-BNC	BNC-Conn.	Solid	Mnt.w/17' RG-58
2252-MUHF	Mini-UHF	Solid	Mnt.w/17' RG-58
2252-N	N	Solid	Mnt.w/17' RG-58

2254 - - Mount Only

UHF 5/8" Hole Mounts

3251	UHF/PL-259	Stranded	Mnt.w/17' RG-58
3253	UHF/PL-259	Stranded	Mnt.w/17' RG-58

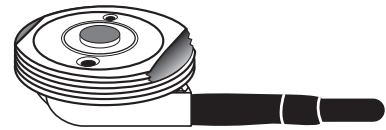

1258
1259
Series



1250 Series

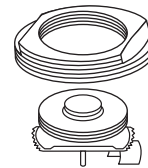
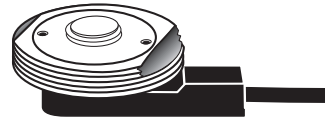

2250 Series

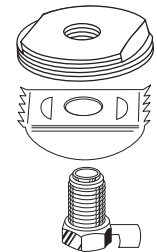
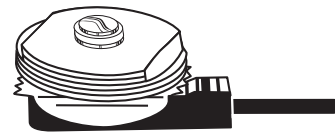

3251

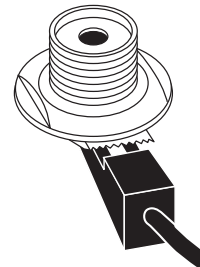

3253

